

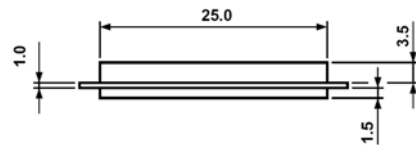

MIFARE Classic / DESFire / EV1

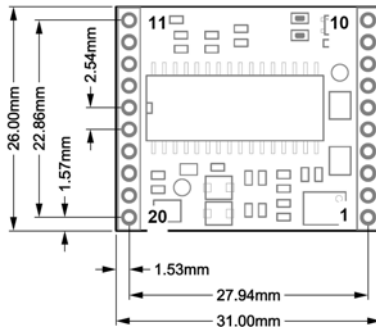

Interface Versions:

- "Serial Asynchronous"
- "SPI"
- "Magstripe"
- "Wiegand"

Firmware / Protocol:

- phg_crypt_SE (serial protocol, asynchronous or SPI)
- active send, data output parametrizable (serial asynchronous, Magstripe oder Wiegand)

Main Features:

- compact design
- external 50 Ohm antenna necessary
- solderable on two 10 pol pin plug (RM 2,54 mm)
- ideal for compact and flexible integration

Accessories:

- external phg 50 Ohm standard antenna (51 x 36 mm)

